

a complete line of vascular access and lead delivery systems

Product Catalog



2 | **Transseptal** Access



10 | **SafeSheath** Introducers and Sealing Adapters



14 | **SafeSheath CS and LV** Introducers



20 | **Right-sided CS/RV Access** Introducer



22 | **CS Venography** Balloons



24 | **Pacemaker** Protection and Comfort



26 | **Hemostatis and Compression** Management



29 | **Accessories**

SafeSept® RF Transseptal Guidewire

Specially designed to improve safety and use radio frequency to cross the interatrial septum at the fossa ovalis while supported by a transseptal introducer.

The SafeSept® Transseptal Guidewire is a nitinol guidewire designed to cross the interatrial septum when supported by a transseptal introducer and be atraumatic when advanced unsupported into the left atrium.

A radiopaque coil is positioned on the distal end of the device to provide visual guidance during the procedure. Dark markers are positioned on the proximal end of the device to provide approximate Transseptal Guidewire tip location relative to the dilator tip during the procedure.

Features

- Engineered to penetrate a tough septum using fewer than 10 watts while remaining inherently incapable of perforating or damaging subsequent cardiac tissue.
- Provides smooth, controlled movement when crossing the fossa, eliminating the "jumping effect" commonly seen with transseptal needles.
- Highly visible under fluoroscopy, ultrasound, and mapping systems prior to introducer advancement.
- NEVA (No Exchange Vascular Access) capability for both J-Tip and retention curves when used as the introducer guidewire.
- Acts as a rail for delivering large structural heart delivery systems.
- Retention curve maintains secure left-atrium positioning.
- Universally compatible with:
 - All commercially available introducers designed for 0.032" and 0.035" guidewires.
 - All standard monopolar electrosurgical units with digitally selectable watt settings.
 - All Transseptal Cannula, providing shapeable curve and column strength for fossa access.

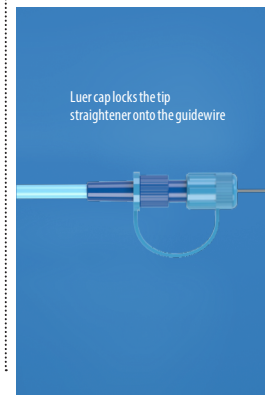

SafeSept RF Transseptal Guidewire, J-Tip

Model	Wire Diameter	Wire Length	Marker Locations
SSRF132	0.032 in (0.81 mm)	180cm	75.1, 84.4, 93.4, 101.0, 110.3 cm
SSRF232	0.032 in (0.81 mm)	230cm	75.1, 84.4, 93.4, 101.0, 110.3 cm
SSRF135	0.035 in (0.89 mm)	180cm	75.1, 84.4, 93.4, 101.0, 110.3 cm
SSRF235	0.035 in (0.89 mm)	230cm	75.1, 84.4, 93.4, 101.0, 110.3 cm

SafeSept RF Transseptal Guidewire, Retention Curve with J-Tip

Model	Wire Diameter	Wire Length	Marker Locations
SSRF132R	0.032 in (0.81 mm)	180cm	75.1, 84.4, 93.4, 101.0, 110.3 cm
SSRF232R	0.032 in (0.81 mm)	230cm	75.1, 84.4, 93.4, 101.0, 110.3 cm
SSRF135R	0.035 in (0.89 mm)	180cm	75.1, 84.4, 93.4, 101.0, 110.3 cm
SSRF235R	0.035 in (0.89 mm)	230cm	75.1, 84.4, 93.4, 101.0, 110.3 cm

SSRF is a registered trademark of Pressure Products Medical Supplies, Inc.

Needle Free Transseptal Cannula

Specially designed to provide support when using the SSRF to cross the interatrial septum.

The Needle Free® Transseptal Cannula replaces a transseptal needle when using the SafeSept® Radio Frequency Transseptal Guidewire for creating the primary puncture in the interatrial septum, providing access through the septum from the right side of the heart to the left side.

Designed to be used with the SafeSept® RF, the Needle Free® Transseptal Cannula comes in equivalent lengths of 71 cm, 89 cm, and 98 cm, and is available in Curve 0 and Curve 1 shapes.

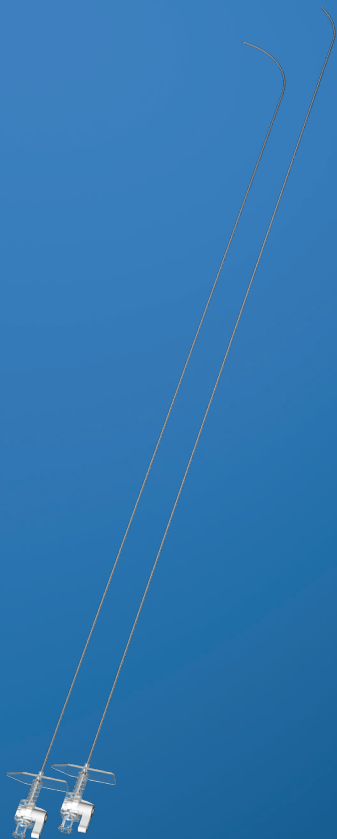

Features

- Clear hub to visualize devices and fluids.
- Light, ergonomic hub with arrow indicator for curve direction.
- Integrated stopcock with arrow indicator on handle.
- Cannula provides column strength to any adult transseptal introducer system.
- Smooth bore on inside of cannula to facilitate passage of SafeSept RF Transseptal Guidewire.
- Non-skiving design.
- Mimics shape of standard transseptal needle curves.
- Available in Curve 0 and Curve 1 shapes.

Needle Free Transseptal Cannula

Model	Description	Size	Length	Curve	Curve Angle
TSC071	71cm Transseptal Cannula	18G	67.7cm	0	38°
TSC089	89cm Transseptal Cannula	18G	87.7cm	0	38°
TSC098	98cm Transseptal Cannula	18G	96.7cm	0	38°
TSC171	71cm Transseptal Cannula	18G	67.7cm	1	72°
TSC189	89cm Transseptal Cannula	18G	87.7cm	1	72°
TSC198	98cm Transseptal Cannula	18G	96.7cm	1	72°

SSRF is a registered trademark of Pressure Products Medical Supplies, Inc.

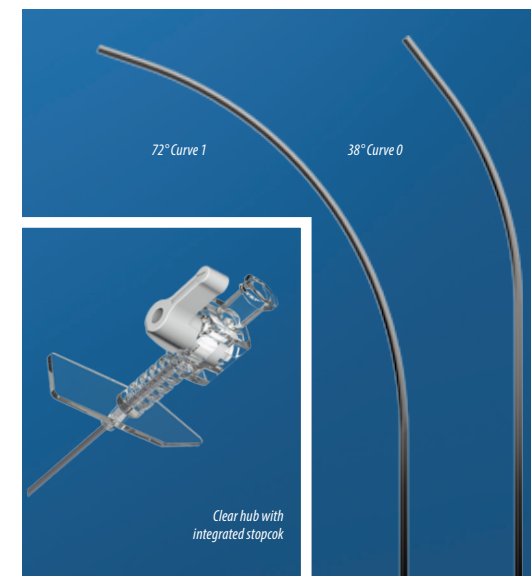

SafeSept® Transseptal Guidewire



Specially designed to improve safety and lessen penetration forces when crossing the interatrial septum at the fossa ovalis while supported by a transseptal introducer.

The SafeSept® Transseptal Guidewire is the first significant advance in left atrial access since the Brockenbrough needle. The SafeSept is a nitinol guidewire specifically designed for transseptal puncture. After the transseptal dilator has “tented” the fossa ovalis, effortless advancement of the SafeSept tip perforates the membranous fossa, requiring 77% less force* than a standard transseptal needle. Unsupported by the needle and dilator, the tip of the wire assumes a ‘J’ shape, rendering it incapable of further tissue penetration.

A radiopaque coil along the shaft allows for fluoroscopic visualization of the wire within the left atrium while proximal marker bands help determine the approximate location of the SafeSept tip in relation to the tip of the needle. The transseptal needle, dilator and sheath are then advanced “over the wire” into the left atrium with virtually no possibility of aortic or pericardial perforation.

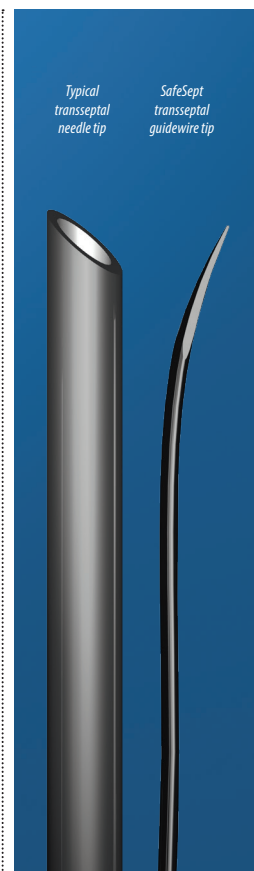

Features

- Radiopaque coil makes the wire easily visible fluoroscopically
- Specially designed tip configuration requires 77% less force* than a standard transseptal needle, enabling effortless penetration of the fossa
- ‘J’ shape allows safe advancement to assure proper wire location within left atrium
- Transseptal needle and dilator are rendered atraumatic when tracking over the SafeSept
- Proximal marker bands help determine SafeSept tip location relative to transseptal needle tip during the procedure
- 135cm length for compatibility with all currently available adult transseptal introducer systems

*Calculated from average transseptal needle and transseptal guidewire puncture forces during in vitro design qualification testing.

SafeSept Transseptal Guidewire		
Model	Length	Diameter
SS-135	135cm	0.014"
SS-140	140cm	0.018"

SafeSept is a registered trademark of Pressure Products Medical Supplies, Inc. Patents 9,821,145; 8,992,556; 8,500,697; 8,292,910; 8,157,829; EP1542593; EP1542593; JP4496223. Other U.S. and worldwide patents pending.

SafeSept Blunt Needle™

Specially designed to create the primary puncture in the interatrial septum when used with the SafeSept® Transseptal Guidewire.

The SafeSept Blunt Needle™ replaces a traditional transseptal needle when using the SafeSept® Transseptal Guidewire for creating the primary puncture in the interatrial septum, providing access through the septum from the right side of the heart to the left side.

Designed to be used with the SafeSept®, the SafeSept Blunt Needle™ comes in equivalent lengths of 71 cm, 89 cm, and 98 cm, and is available in Curve 0 and Curve 1 shapes.

Reduce your risk of complications, and turn the stress of a transseptal stick into a routine procedure.

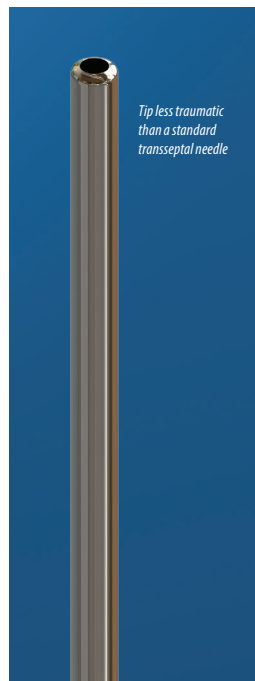

Features

- SafeSept Blunt Needle™ requires 10% less insertion force* than a standard transseptal needle when inserted over a SafeSept® Transseptal Guidewire
- SafeSept Blunt Needle™ requires 36% less insertion force* with a SafeSept® Transseptal Guidewire than a standard transseptal needle without a SafeSept® Transseptal Guidewire*
- SafeSept Blunt Needle™ tip is less traumatic, requiring 2.5 times more force* to puncture than a standard transseptal needle tip without a SafeSept® Transseptal Guidewire*
- Non skiving design
- Clear hub to visualize devices and fluids
- Ergonomic hub with integrated stopcock and arrow indicator for curve direction
- Blunt Needle provides column support to any adult transseptal introducer system
- Smooth bore on inside of cannula to facilitate smooth passage of SafeSept® Transseptal Guidewire
- Mimics shape of standard transseptal needle curves
- Available in Curve 0 and Curve 1 shapes

*Calculated from average SafeSept Blunt Needle™ and transseptal needle puncture forces during in vitro design qualification testing.

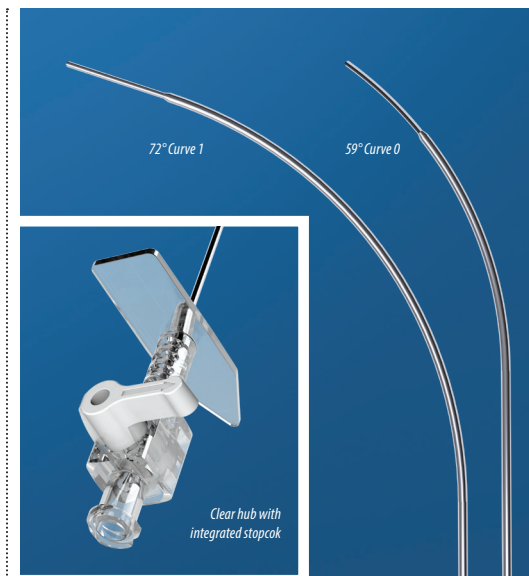

SafeSept Blunt Needle

Model	Size	Length	Curve	Curve Angle
SBN071	18G/21G	71cm	0	59°
SBN089	18G/21G	89cm	0	59°
SBN098	18G/21G	98cm	0	59°
SBN171	18G/21G	71cm	1	72°
SBN189	18G/21G	89cm	1	72°
SBN198	18G/21G	98cm	1	72°

SafeSept is a registered trademark of Pressure Products Medical Supplies, Inc.

SafeSheath® II



Time-tested design of a tear-away sheath and hemostatic valve with new and improved features to reduce back bleeding and the possibility of air embolism during venous access.

Building on the success of the original, SafeSheath II continues to revolutionize venous access, setting new standards for performance and features, and facilitating better outcomes.

SafeSheath II Introduced into the subclavian vein in the standard manner, the hemostatic valve of the SafeSheath II seals the device during lead introduction and positioning.

The easy splitting, ergonomically-shaped break-away hub greatly simplifies sheath removal after lead or catheter placement. Extruded score line construction ensures a clean, even peel every time. A new elastomer snap-locking dilator connector assures a firm attachment to the sheath.

The three-way stopcock side port provides a convenient means of aspirating and flushing the introducer, as well as for contrast and fluid administration. Finally, the advanced design of the lubricated

hemostatic valve enables low insertion and withdrawal forces, delivering greater control during lead manipulation.

SafeSheath II Long The 23cm Long provides access beyond the right subclavian-SVC junction, from both the left cephalic and subclavian veins. The extra length helps when upgrading existing systems by the addition of new leads and for atypical venous access sites—axillary or femoral. It also acts as a ‘supporting’ platform for the introduction of defibrillator leads.



Features

- Standard 13cm length for access to subclavian vein, and 23 cm Long model for access beyond the right subclavian-SVC junction
- Extruded score line peel-away sheath for clean, even peeling during removal
- Longer, smoother sheath tip to dilator transition for ease during insertion
- Lubricated hemostatic valve with low insertion and withdrawal forces yields greater control during lead manipulation and reduces risk of blood loss and air embolism
- Convenient sideport with three-way stopcock for infusion and contrast injection, like the original SafeSheath
- Wide range of French sizes
- French size on handle and indicated by color-coded introducer cap
- Elastomer snap-locking dilator connector like the original SafeSheath with French size embossed on handle
- Ergonomic, easy-splitting break-away hub

Hemostatic Peel-away Introducer System for Vascular Access

SafeSheath II Tear-away valved hemostatic sheath system w/side port

Model	Size	Hub Color	Dilator Length	Length
SS6	6.0 French	Green	13cm	19.5cm
SS7	7.0 French	Orange	13cm	19.5cm
SS8	8.0 French	Blue	13cm	19.5cm
SS85	8.5 French	Light Blue	13cm	19.5cm
SS9	9.0 French	Black	13cm	19.5cm
SS95	9.5 French	Light Black	13cm	19.5cm
SS10	10.0 French	Fuschia	13cm	19.5cm
SS105	10.5 French	Light Fuschia	13cm	19.5cm
SS11	11.0 French	Yellow	13cm	19.5cm
SS12	12.0 French	Brown	13cm	19.5cm
SS125	12.5 French	Light Brown	13cm	19.5cm

Guide Wire for standard SafeSheath is 50cm long with O.D. of .038"

SafeSheath II Long Tear-away valved hemostatic sheath system w/side port

Model	Size	Hub Color	Dilator Length	Length
SSL6	6.0 French	Green	23cm	29.5cm
SSL7	7.0 French	Orange	23cm	29.5cm
SSL8	8.0 French	Blue	23cm	29.5cm
SSL9	9.0 French	Black	23cm	29.5cm
SSL10	10.0 French	Fuschia	23cm	29.5cm
SSL105	10.5 French	Light Fuschia	23cm	29.5cm
SSL11	11.0 French	Yellow	23cm	29.5cm

Guide Wire for SafeSheath Long is 60cm long with O.D. of .038

All SafeSheath Introducer Systems include sheath, dilator, needle and syringe. SafeSheath is a registered trademark of Pressure Products Medical Supplies, Inc.

Hemostatic Valve System

SafeSheath® Sealing Adapter

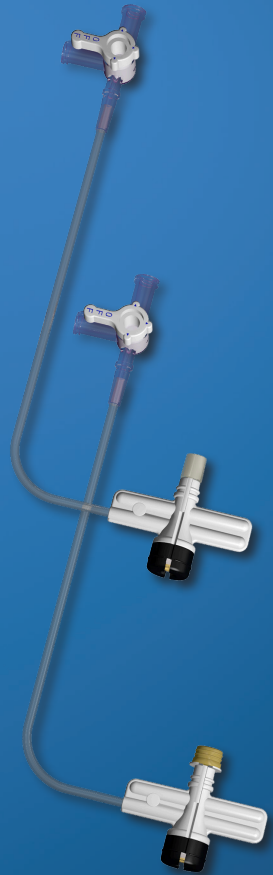

The Sealing Adapter provides the convenience of the SafeSheath splittable valved system when using a Medtronic Attain™ or St. Jude Medical CPS® Introducer.

Every SafeSheath Sealing Adapter provides an air- and fluid-tight seal between it and the introducer. Its specially-designed valve allows insertion of single or multiple wires while remaining hemostatic, reducing back bleeding and the possibility of air embolism during lead introduction or exchange.

The convenient sideport allows aspiration and flushing of the introducer, as well contrast and fluid administration. And after lead or catheter placement, the

easy-splitting, break-away hub greatly simplifies device removal.

Each Sealing Adapter for the Medtronic Attain comes with a press-fit connector insuring a secure attachment between adapter and sheath.

The slot-locking mechanism of the Sealing Adapter for St. Jude Medical CPS introducers creates a tight seal with both braided and non-braided models.

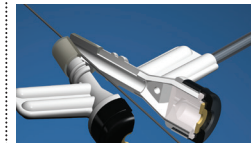
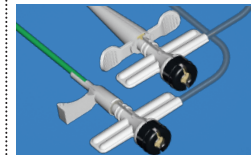
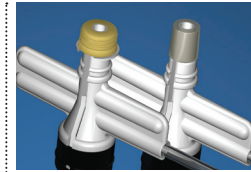

Features

- Unique press-fit connector for Medtronic Attain introducers
- Slot-locking mechanism designed to securely attach to St. Jude Medical CPS introducers.
- Fluid- and air-tight seal between Sealing Adapter and introducer
- Innovative tear-away design with break-away hemostasis valve
- Remains hemostatic when multiple wires are within it, as well as when leads need to be introduced or exchanged
- Reduced risk of blood loss and air embolism
- A side port for “keep open” infusion

SafeSheath Sealing Adapter for Medtronic Attain™ Introducers

Model	Size	Hub Color	Description
SS-SA-09	9.0 French	Black	Standard Wing for Attain Introducers

SafeSheath Sealing Adapter for St. Jude Medical CPS® Introducers

Model	Size	Hub Color	Description
410195	9.0 French	Black	Standard Wing for CPS Introducers with Slot-Locking Mechanism

The H. Lee SafeSheath® hemostatic splittable sheath is protected by Patent Insurance. USA Patent 8,048,061. Canadian Patent 2,493,189. European Patent EP 15-45677. Japanese Patent 4705779. Other Worldwide Patents pending. SafeSheath is a registered trademark of Pressure Products Medical Supplies, Inc. Attain is a trademark of Medtronic, Inc. CPS is registered trademark of St. Jude Medical.

SafeSheath® CSG® Worley Braided Core Series



Splittable-valved, peel-away hemostatic introducer system combined with a high-torque, radiopaque-tipped sheath and braided core for CS access.

The SafeSheath CSG's braided core provides improved torque control. Both the introducer and core are radiopaque-tipped for better fluoroscopic visualization. Multiple introducer angles and the advancable core improve ease of CS placement.

The CSG enters the coronary sinus and remains in position during angiography and lead placement, remaining hemostatic during subsequent procedures.

Worley Curve The SafeSheath CSG Worley Braided Core line of introducers incorporate a unique sheath curve. Designed specifically for ventricular resynchronization therapy where the right-sided chamber is significantly dilated, the long gentle throw of the Worley causes its tip to virtually fall into the coronary sinus OS. Various shapes can be created by advancing the braided core into the sheath, better facilitating CS cannulation.

Made from crush-resistant material, the CSG Worley is available in standard, long and jumbo sizes, enabling access to any anatomy. All 9 French CSG sheaths can be used as a coronary sinus access platform for our family of CSG Worley Telescoping LV introducers.

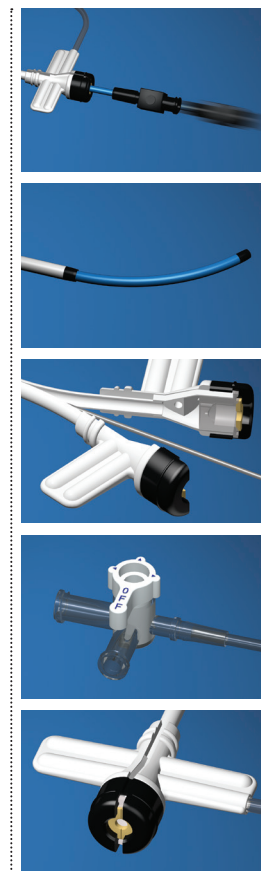
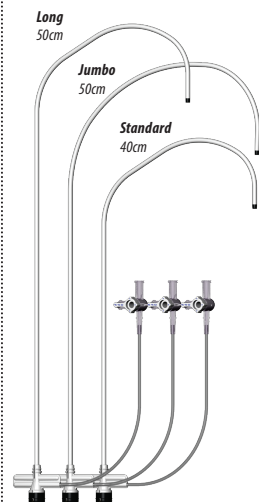

Features

- Braided, soft-tipped core for improved torque control and stability
- Peel-away sheath with break-away hemostasis valve
- Radiopaque tip marker on sheath and core for improved fluoroscopic visualization
- Multiple angles for CS lead placement
- Side port for "keep open" infusion and contrast injection
- Reduces risk of blood loss and air embolism
- Handles like standard peel-away introducer
- May be left in position during placement of other leads
- Permits lead exchange quickly, without further interventions or "sticks"

Hemostatic Peel-away Introducer System with Braided Core for CS Access

Using the Braided Core

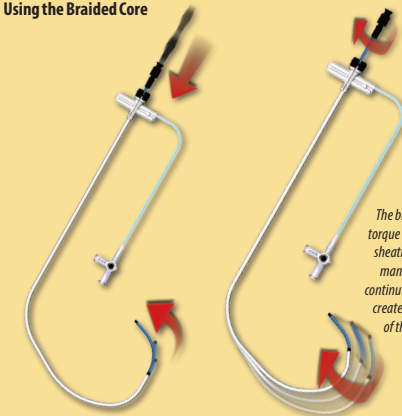

The braided core provides torque control for the outer sheath. By advancing and manipulating the core, a continuum of shapes can be created, aiding in location of the coronary sinus OS

SafeSheath CSG Worley Tear-away valved hemostatic sheath system w/side port for CS access

Model	Curve	Length	Size	O.D.	I.D.	Tip I.D.
CSG/WORLEY/BCor-1-09	Standard	40cm	9 French I.D.	0.157"	0.130"	0.122"
CSG/WORLEY/L/BCor-1-09	Standard	50cm	9 French I.D.	0.157"	0.130"	0.122"
CSG/WORLEY/BCor-2-09	Jumbo	50cm	9 French I.D.	0.157"	0.130"	0.122"
<i>Each kit includes:</i>						
P.T.F.E. Guide Wire		135cm		0.035"	—	—
Curved Guiding Core (9F introducers)		—		0.118"	0.095"	0.092"
Curved Guiding Core (7F introducers)		—		0.095"	0.072"	0.069"
Straight Vessel Dilator		—		—	—	0.038"
Transvalvular Insertion Tool (TVI)	1.75"	7 French		0.117"	0.097"	—
Needle	2.75"	18 gauge		—	—	—
Syringe	—	12cc		—	—	—

The SafeSheath CSG Worley Introducer Systems include sheath, guiding core, vessel dilator, guide wire, TVI, (transvalvular insertion tool), needle and syringe. The H. Lee SafeSheath® CSG® splittable hemostatic sheaths are protected by Patent Insurance. USA Patent 7,462,184, European Patent EP1360972. Other USA and Worldwide Patents pending. SafeSheath and CSG are a registered trademarks of Pressure Products Medical Supplies, Inc.

SafeSheath® CSG® Extruded Core Series



Splittable-valved, peel-away hemostatic introducer system with radiopaque-tipped sheath and shapeable, extruded core for coronary sinus access.

SafeSheath CSG enters the coronary sinus and remains in position during angiography and lead placement, remaining hemostatic during subsequent procedures.

SafeSheath CSG The multipurpose 90° curve of our original CSG enables ease of CS cannulation, while the improved tip transition results in less traumatic tip placement.

SafeSheath CSG Worley Incorporating a unique sheath curve, the Worley is designed specifically for ventricular resynchronization therapy where the right-sided chamber is significantly dilated, its long gentle throw causing its tip to virtually fall into the coronary sinus OS. The CSG Worley is also made from crush-resistant material and is available in standard, long and jumbo sizes.

All CSGs can be used as a coronary sinus access platform for our family of Worley Telescoping LV introducers.

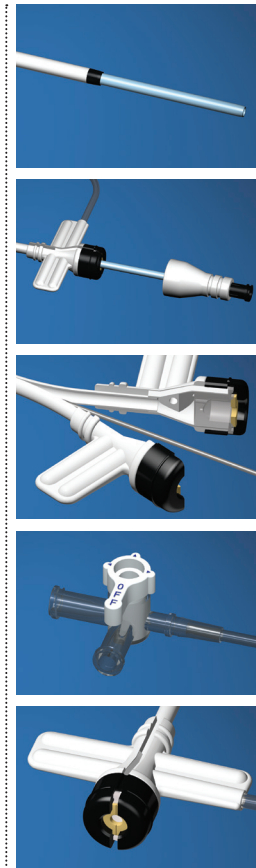
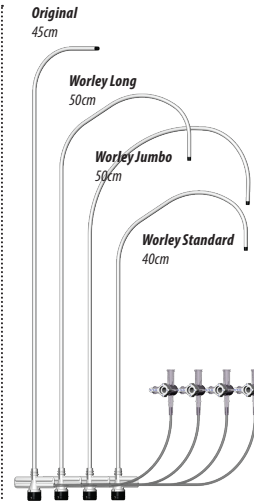

Features

- Innovative peel-away sheath with break-away hemostasis valve
- Radiopaque tip on sheath for better fluoroscopic visualization
- Multiple angles and a shapeable core aid in CS lead placement
- Side port for “keep open” infusion and contrast injection
- Reduces risk of blood loss and air embolism
- Handles like standard tear-away introducer
- May be left in position during placement of other leads
- Permits lead exchange quickly, without further interventions or “sticks”

Hemostatic Peel-away Introducer System for CS Access

SafeSheath CSG Worley Tear-away valved hemostatic sheath system w/side port for CS access

Model	Curve	Length	Size	O.D.	I.D.	Tip I.D.
CSG/WORLEY-1-09	Standard	40cm	9 French I.D.	0.157"	0.130"	0.122"
CSG/WORLEY/L-1-09	Standard	50cm	9 French I.D.	0.157"	0.130"	0.122"
CSG/WORLEY-2-09	Jumbo	50cm	9 French I.D.	0.157"	0.130"	0.122"

SafeSheath CSG Tear-away valved hemostatic sheath system w/side port for CS access

Model	Curve	Length	Size	O.D.	I.D.	Tip I.D.
CSG-90-09	90° curve	45cm	9 French I.D.	0.157"	0.130"	0.122"

Each kit includes:

P.T.F.E. Guide Wire	45° angle	135cm	—	0.035"	—	—
Curved Guiding Dilator	90° angle	63.9cm	—	0.118"	0.042"	0.038"
Worley 1 Guiding Dilator	180° angle	44.3cm	—	0.118"	0.042"	0.038"
Worley 2 Guiding Dilator	180° angle	53.3cm	—	0.118"	0.042"	0.038"
Worley L Guiding Dilator	180° angle	53.3cm	—	0.118"	0.042"	0.038"
Straight Vessel Dilator	—	—	—	—	—	—
Transvalvular Insertion Tool (TVI)	—	1.75"	7 French	0.119"	0.099"	—
Needle	—	2.75"	18 gauge	—	—	—

The SafeSheath CSG and CSG Worley Introducer Systems include sheath, guiding dilator, vessel dilator, guide wire, TVI, (transvalvular insertion tool), and needle. The H. Lee SafeSheath® CSG® splittable hemostatic sheaths are protected by Patent Insurance. USA Patent 7,462,184. European Patent EP1360972. Other USA and Worldwide Patents pending. SafeSheath and CSG are a registered trademarks of Pressure Products Medical Supplies, Inc.

SafeSheath® Worley Telescopic LV Introducers

Uniquely-shaped, braided, high-torque, 7 French I.D. sliceable hemostatic introducer system with Target Vein Selector for sub-selective access during LV lead placement.

Reduce Implant Times 30-50%

Successful Cardiac resynchronization therapy (CRT) requires accurate delivery of the pacing lead to specific postero-lateral epicardial LV pacing sites via the coronary sinus. Available in four unique curves, the LVI provides sub-selective access to the target vein. When combined with our new Target Vein Selector, better, more reliable access to the chosen vessel is achieved, no matter what the situation.

When deployed through the LVI, the 5 French O.D. Target Vein Selector is the easiest way to locate and cannulate the target vein, serving as a "rail" for advancing the LV introducer into the vein.

For delivery of larger, more stable leads, the 7 French LVI's braided construction and multidurometer reinforced proximal curve delivers increased torque control and tip directivity, providing needed support and stability during procedures.

When deployed through the LVI, the new 5 French O.D. Target Vein Selector is the easiest way to locate and cannulate the target vein, serving as a "rail" for advancing the LVI into the vein. The SafeSheath LVI provides needed support and stability during implant procedures, for delivery of larger, more stable leads.

Contrast injection is easily accomplished with the LVI's convenient sideport, while the radiopaque tip marker enhances fluoroscopic visualization during procedures.

The unique, breakaway hub requires no plastic to cut through, reducing the risk of lead dislodgement, while the integrated handle stays firmly attached to the sheath, helping with control and stability during slicing and removal. Finally, the advanced cutter material of the LVI sheath offers uniform resistance during slicing with the user-friendly cutter.



Features

- 7 French I.D. introducer provides support and stability for easier, reliable delivery of larger, more stable leads despite tortuous anatomy
- 5 French O.D. Target Vein Selector makes target vessel identification and guide wire placement a snap, greatly reducing implant times
- Unique combination of proximal and distal curves for sub-selective access to angulated lateral vein branches
- Braided sheath construction for better torque control and stability with multidurometer proximal curve for improved tip directivity
- Break-away hub with integrated handle requires no cutting and provides a secure grip during slicing
- Radiopaque tip marker on introducer for enhanced fluoroscopic visualization
- Easy-to-use slicer mates to the SafeSheath hub to create a stable platform for the cutting hand
- Side port for "keep open" infusion and convenient contrast injection
- Hemostatic hub reduces the risk of blood loss and air embolism

Hemostatic Introducer System for sub-selective access during LV lead placement

SafeSheath® Worley Telescopic LVI System

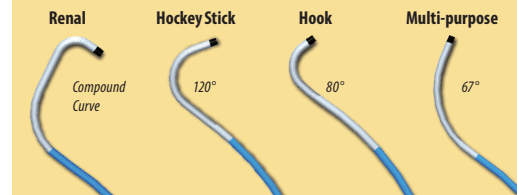

SafeSheath Worley LVI Sliceable hemostatic introducer system w/side port for LV access

Model	Shape/Curve	Length	Size	Max. O.D.	Min. I.D.	Min. Tip I.D.
LVI/75-5-62-07-RE	Renal / Compound	62cm	7F.I.D.	0.120"	0.090"	0.090"
LVI/75-5-62-07-HO	Hook / 80°	62cm	7F.I.D.	0.120"	0.090"	0.090"
LVI/75-5-62-07-HS	Hockey stick / 120°	62cm	7F.I.D.	0.120"	0.090"	0.090"
LVI/75-5-62-07-MP	Multi-purpose / 67°	62cm	7F.I.D.	0.120"	0.090"	0.090"

Each kit includes:

Transvalvular Insertion Tool (T.V.I.)	1.75"	7F	0.121"	0.089"	—
Slicer	—	—	—	—	—
Target Vein Selector	75cm	—	5F	.041" ± .001"	—

The SafeSheath Worley Telescopic Series of Lateral Vein Introducer Systems includes sheath, T.V.I. (transvalvular insertion tool), Slicer and Target Vein Selector. The H. Lee SafeSheath® CSG® splittable and SafeSheath® CSG® Braided sliceable hemostatic sheaths are protected by Patent Insurance. USA Patents 5,409,463, 6,966,896, 7,384,422 and 7,993,351. Japanese Patent 4695878. European Patents EP1539277 and EP1542630. The Braided Sheath Cutter is covered by USA Patent 6,497,681. Other USA and Worldwide Patents pending. SafeSheath and CSG are registered trademarks of Pressure Products Medical Supplies, Inc.

SafeSheath® II Worley Right-sided Access Introducer



Gains access to the RA, for delivery of catheters into the CS or pacing leads into the right ventricle making right-sided LV or RV access as easy as coming from the left.

The specially designed shape of the 23cm SafeSheath II Worley Right-sided Access Introducer makes right-sided LV or RV access as easy as coming from the left, virtually eliminating the kinking that sometimes occurs when approaching from the right side with a straight introducer.

The unique distal curve when positioned in the high RA, provides a convenient pivot point for directing CS access catheters to the coronary sinus, such as the SafeSheath Worley Telescopic LV introducer system,

creating a stable work platform for better control during lead placement, and reduced risk of lead dislodgement during CS catheter removal. The Right-sided introducer is also perfect for placing leads into the RV and right ventricular outflow tract.

The SafeSheath II Worley Right-sided Access Introducer is a breakthrough technology for left ventricular pacing from the right subclavian and is also an excellent platform for standard RV pacing.



Features

- Curved shape designed for making right-sided access during BiV LV procedures as easy as approaching from left side
- Enables access to the RA, for delivery of catheters into the CS or pacing leads into the right ventricle
- Virtually no chance of kinking during right-sided access introduction
- Uniquely shaped distal curve acts as a pivot point for CS access catheter, for stability and control during lead placement and removal
- Ergonomic, easy-splitting break-away hub and extruded score line peel-away sheath for clean, even peeling during removal
- Hemostatic valve with low insertion and withdrawal forces permits multiple lead insertions without further interventions
- Convenient sideport with three-way stopcock for infusion and contrast injection
- Elastomer snap-locking dilator connector with French size embossed on handle

SafeSheath II Worley Right-sided Access Introducer

Model	Size	Hub Color	Length	Dilator Length
SSR9	9.0 French	Black	23cm	28cm

Guide Wire for SafeSheath II Worley Right-sided Access Introducer is 50cm long with O.D. of .038"

CS Balloon Venography Catheter CS Venous System Visualization Aid



The Coronary Sinus Balloon Venography Catheter system Aids visualization of the CS venous system during left ventricular epicardial lead placement.*

The Coronary Sinus Balloon Venography Catheter* is designed for placement in the proximal coronary sinus via SafeSheath® CSG® introducer. When inflated, the coronary sinus is occluded and venography easily accomplished.

The CS Balloon Venography Catheter features a 1cm diameter balloon and a port for distal contrast injection or guidewire placement.

*Manufactured by B. Braun Medical Inc., Bethlehem, PA 18018-3524 USA

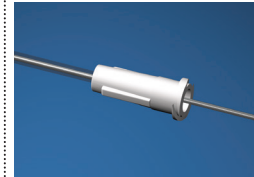
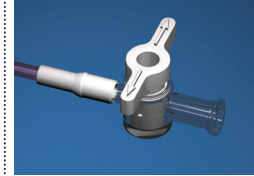
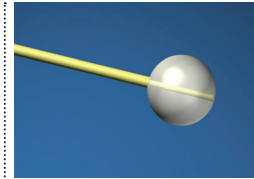

Features

- 1cm diameter Balloon
- Useful for occlusion of the CS
- Aids visualization of the coronary sinus venous system
- Inner lumen for contrast injection or guidewire placement
- Markers every 10cm from proximal tip
- Designed to work with the SafeSheath CSG and Worley line of LV introducers, as well as SafeSheath Sealing Adapters

Soft Tip Balloon Venography Catheter

Model	Size	Lumens	Length
BVCS 6180	6.0 French	2	80cm

SoftTouch™ Seat Belt Pad

Provides comfort and protection to those with pacemakers, defibrillators, chemotherapy ports, or other medical conditions while wearing a seat belt.

The patented SoftTouch seat belt pad is designed to provide comfort and a level of protection to your patients with implanted devices or other medical conditions while wearing a seat belt. SoftTouch provides support and comfort during everyday travel for patients with:

- Pacemakers
- Defibrillators
- Mastectomies
- Chemotherapy ports
- Other medical conditions
- When seat belt irritation is a problem

Made with polyurethane and silicone gel, the unique design and construction of the SoftTouch pad enables the medical device to sit in a free air space, reducing the forces over the region where the device is positioned, better protecting the driver in the event of an automobile accident.

SoftTouch lifts the shoulder belt like a bridge over the pacemaker implant area, eliminating direct contact between the medical device and the belt while at the same time lessening the discomfort from vibration transmission.



Features

- Eliminates seat belt irritation
- Reduces compressive force over implant site
- Polyurethane and silicone gel construction
- Lessens transmission of vibration

SoftTouch Seat Belt Pad

Model	Size
ST-1	fits most adults

U.S.A. Patent 6,557,895. SoftTouch is a trademark of Pressure Products Medical Supplies, Inc.

comfortHer™ Post Surgery Bra Strap Pad

Provides post-operative comfort from bra strap irritation of the surgical site following implantation of a pacemaker or other medical device or procedure.



Following implantation of a pacemaker, defibrillator, chemotherapy port, or other medical procedure, your patient's bra strap can irritate the surgical site.

The fully adjustable comfortHer cushion provides post-operative comfort to the affected area when wearing a bra.

Made of a silky-soft, washable tricot nylon fabric with triple-padding and unique internal stiffeners, the comfortHer pad gently protects the post-surgical area from the constant rubbing of the bra strap during everyday activities.

Easily adjusted to fit any bra, the comfortHer pad's low profile enables it to be worn under most any clothing without being seen.



Adjustable Velcro™ strips allow comfortHer to be used with almost any bra strap.

Features

- Fits on any bra strap
- Silky-feel tricot nylon fabric
- Triple padded for total comfort
- Low profile
- Washable

comfortHer Post-Surgery Bra Strap Pad

Model	Size
CH-1	fits most adults

comfortHer is a trademark of Pressure Products Medical Supplies, Inc.



Pocket Pal II™ Device Pocket Compression Harness with Cooling Gel Pack

Pocket Pal II was designed to provide moderate direct pocket compression and a means for cooling of the operative site in the immediate post-surgical period.

Clinical experience has shown that moderate compression of the pacemaker pocket may result in a decreased incidence of post-operative hematoma formation. Additionally, considerable literature demonstrates that cooling of an operative incision reduces capillary blood flow, thereby decreasing both incisional pain and swelling.

Pocket Pal II conveniently combines these two principles in a single, unique device. An elastic and velcro harness provides moderate, direct incisional compression while decreasing patient upper extremity motion. The compression apron houses a pouch designed to position a cooling gel pack directly over the fresh device pocket.

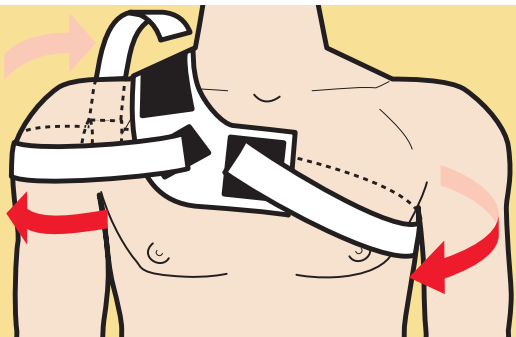
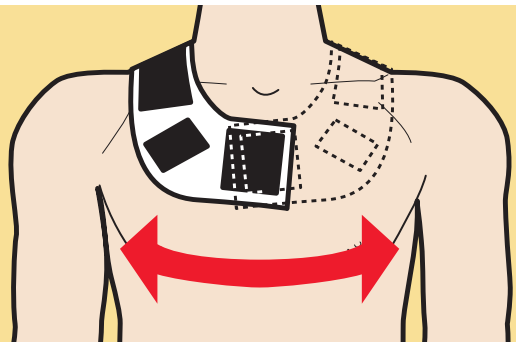

Pocket Pal II compression harness with cooling Gel Pack

Model	Size
PP-101	fits most adults

Protected by Patent Insurance. Patented in USA. Worldwide Patents Pending. Pocket Pal is a trademark of Pressure Products Medical Supplies, Inc.



HOLD Hemostatic Occlusive Leverage Device

Maintains pressure over femoral arterial or venous puncture site after cardiac catheterization, coronary arteriography or renal/peripheral arteriography



The Hemostatic Occlusive Leverage Device (HOLD) was designed to apply direct pressure over the puncture site following cardiac catheterization via the femoral artery or vein without the discomfort associated with the application and removal of an adhesive dressing or the difficulty with maintaining sandbags in a stable position.

Pressure is maintained over the area of femoral puncture for as long as is clinically desired. No extensive skin preparation is required, and no adhesive is applied to the patient. HOLD applies constant pressure using the force applied via an elasticized groin strap, and maintained in position by a pelvic apron. The device is easily applied and removed without any patient discomfort.

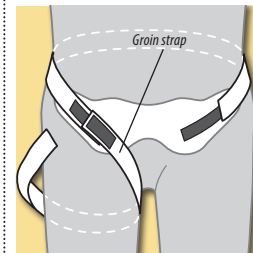
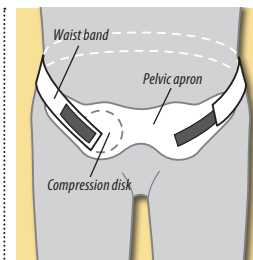
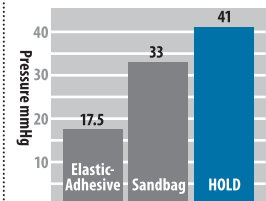

Features

- Avoids risk of skin abrasion and tape allergies
- No need for skin preparation or shaving
- Obviates need for heavy sandbags or adhesives
- Results in prolonged application of greater direct pressure to either femoral artery or vein

HOLD Hemostatic Occlusive Leverage Device

Model	Size
H-100S	Standard
H-150L	Large
H-200XL	Extra Large

HOLD is a trademark of Pressure Products Medical Supplies, Inc.

HEMobilizer® Immobilization of the Groin and Femoral Arterial Puncture Site

For immobilization of the groin and femoral arterial puncture site during prolonged procedures or when arterial sheaths are left indwelling.

The HEMobilizer® device is designed to immobilize the groin and femoral area following femoral arterial puncture or when femoral arterial sheaths are to be left in place for extended periods of time.

The device principle is simple. By immobilizing the knee and precluding both flexion (by means of the HEMobilizer 'stays') as well as medial and lateral motion (by means of the straps) significant motion at the catheterization site is eliminated.

HEMobilizer is ideal in the setting of:

- Cardiac catheterization
- Intra-aortic balloon pump procedures
- Coronary arteriography/angiography
- Coronary angioplasty
- Cerebral/renal/peripheral arteriography
- Valvuloplasty procedures

HEMobilizer is particularly well suited for situations where prolonged bleeding times and/or procedures are expected.

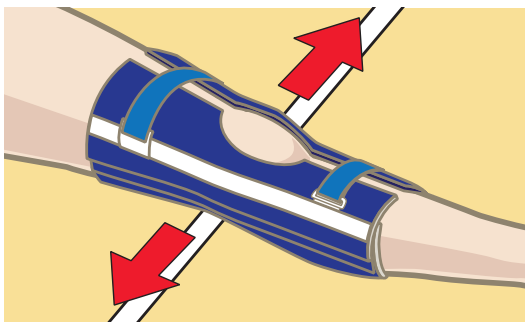
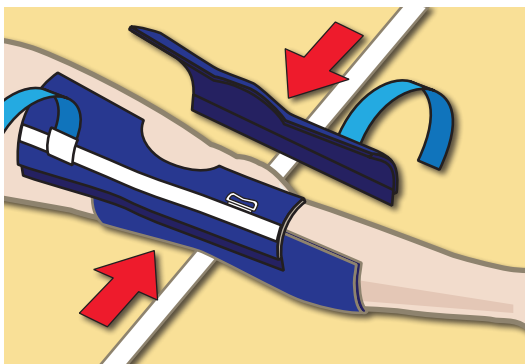

HEMobilizer Device for immobilization of the groin and femoral arterial puncture site

Model	Size
1200	fits most adults

Worldwide Patent pending. HEMobilizer is a registered trademark of Pressure Products Medical Supplies, Inc.

Transvalvular Insertion Tool (TVI)



An aid for opening a SafeSheath® hemostatic valve during the introduction of various types of pacing or defibrillator leads and catheters.

The Transvalvular Insertion Tool (TVI) is designed to open the valve for lead placement via the SafeSheath® and SafeSheath® CSG® family of introducers and Sealing Adapters. When inserted into the valve housing of the introducer, the

7 French TVI aids insertion and advancement of a pacemaker lead through the sheath. The TVI may then either be withdrawn and peeled away or left resting on the shaft of the pacemaker lead.

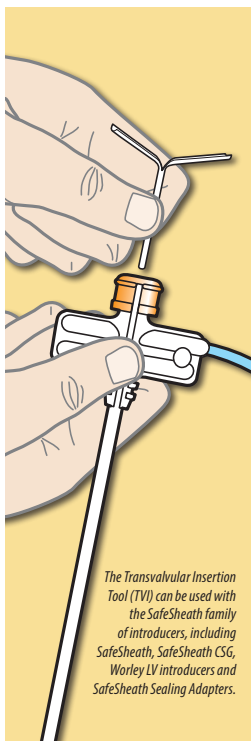

The Transvalvular Insertion Tool (TVI) is designed to open the valve for lead placement via the SafeSheath® and SafeSheath® CSG® family of introducers and Sealing Adapters. When inserted into the valve housing of the introducer, the 7 French TVI aids insertion and advancement of a pacemaker lead through the sheath. The TVI may then either be withdrawn and peeled away or left resting on the shaft of the pacemaker lead.

Features

- Opens the valve of a SafeSheath introducer or Sealing Adapter for placement of lead or catheter
- Can be used with leads up to 9 French
- Easily peeled away after lead placement

Transvalvular Insertion Tool (TVI)

Model	Size	Max. Lead Size
TVI-07	7 French	6.2 French



Customer Service

1861 N. Gaffey Street Suite B San Pedro, CA 90731
 (310) 547-4973 Fax (310) 547-4760
www.pressure-products.com